

PLANNING PROPOSAL

Amendment to Parramatta Local Environmental Plan 2011 for Additional Building Height, Additional Floor Space Ratio and Additional Permitted Use for Short-Term Accommodation
93 Bridge Road, Westmead (SP 31901)



Figure 1. Existing Site Development (SIX Maps 2019)

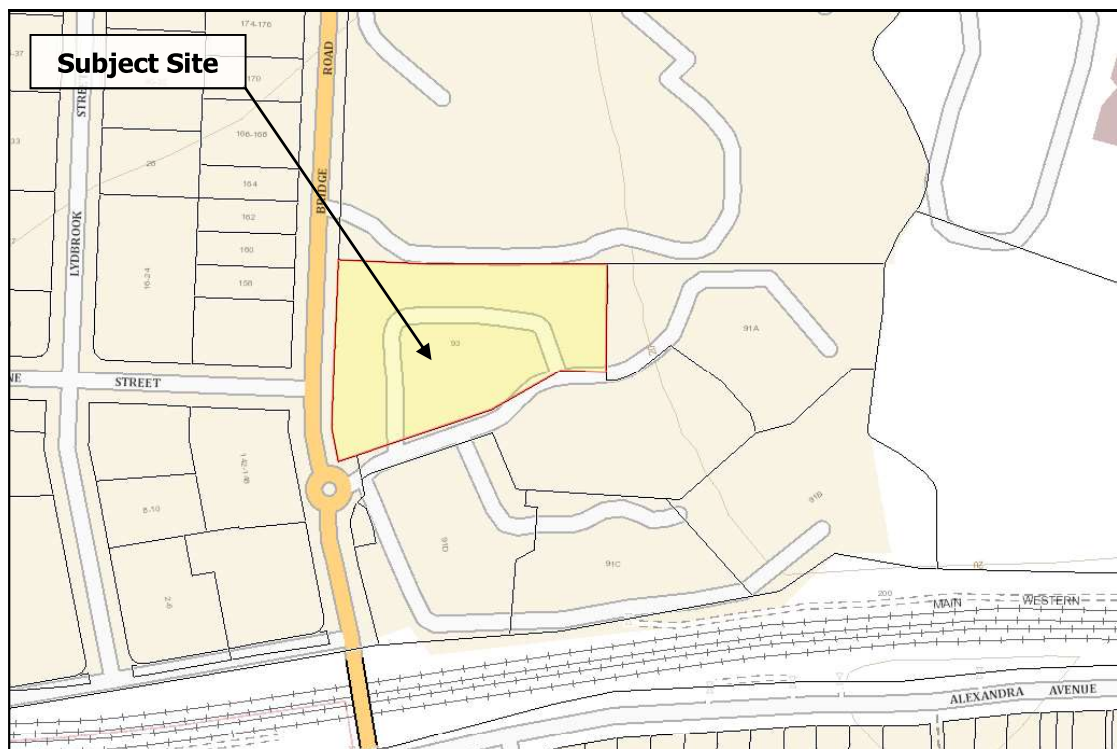

Figure 2. Cadastral Map (SIX Maps 2019)